



1455 E Francis Ave
Ontario, Ca., 91761
866 930-1898

FULL MORTISE TEMPLATE HINGES
SPRING HINGE – STANDARD WEIGHT
4 ½ X 4 ½ “

SPR0206
ANSI (K81071F)
Steel – Polished and Plated or
Bonderized and Prime Coated

SSSPR0206
ANSI (K51071F)
Stainless Steel-
Polished and Satin Finish

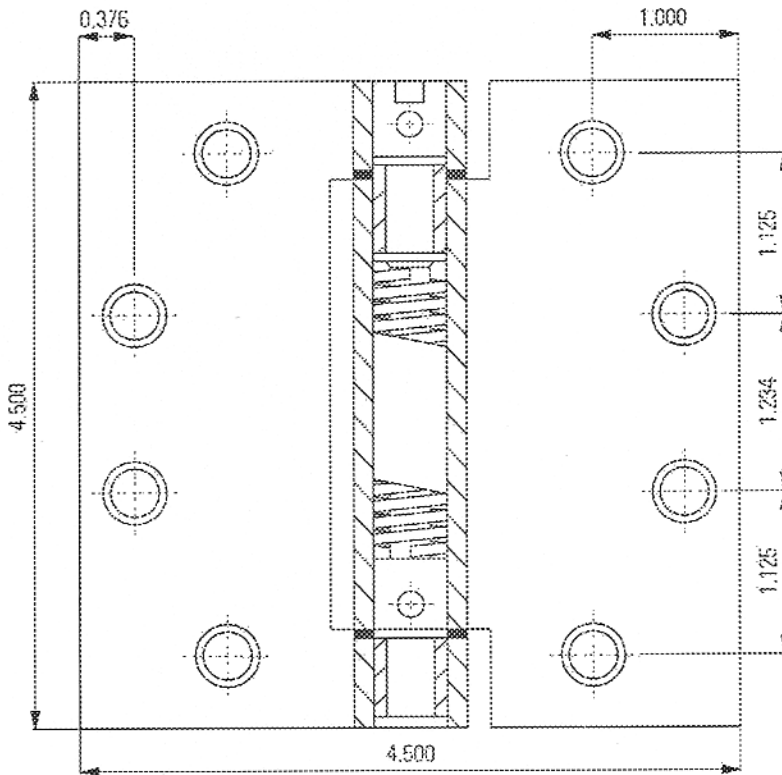

General Product Information:
Manufacturer: Ameriwest
Industries/Tempo Division
All hinges comply with American
National Standards Institute 156.1 Full
Mortise Hinges

Hinge Specifications:

Material Gauge: 3.3mm (.130+-.005)
Material Width: 114mm (4.50+-.015)
Material Height: 114mm (4.50+-.015)

All hole patterns are ANSI template

Standard hinge swag 1/16" closed
parallel position.

NOTES:

1. For complete warranty protection use all spring hinges or a combination of spring and ball bearing hinges.
 2. Use of gaskets for smoke or sound protection, wind conditions or unbalanced air pressure may prevent door from latching. Additional closing power would be required.
- See installation instruction sheet.



Packaging Information:

1 ½ pair per box – 18 boxes per case – 54 hinges total in case
1 screw pack containing 24 FHMS #12 X ½" and 24 FHWS #12 X 1 ¼"